

CLASS 150 FLANGES

LONG WELDING NECK

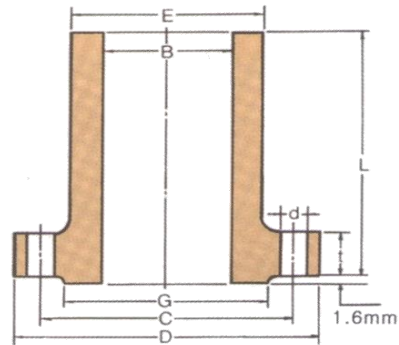

Long Welding Neck Flanges

Class 150

Unit: mm

Nominal Pipe Size	Outside Diam	O.D. of Raised face	Hub Diameter of Bevel	Diameter of Bore	Thickness of Flange Min.	Length through Hub	Drilling Template		
							Diameter or bolt circle	Number of holes	Diameter of holes
	D	G	E	B	t	L	C		d
½	90	34.9	30	12.7	9.6	228.6	60.3	4	15.9
¾	100	42.9	38	19.1	11.2	228.6	69.9	4	15.9
1	110	50.8	49	25.4	12.7	228.6	79.4	4	15.9
1 ¼	115	63.5	59	31.8	14.3	228.6	88.9	4	15.9
1 ½	125	73.0	65	38.1	15.9	228.6	98.4	4	15.9
2	150	92.1	78	50.8	17.5	228.6	120.7	4	19.1
2 ½	180	104.8	90	63.5	20.7	228.6	139.7	4	19.1
3	190	127.0	108	76.2	22.3	228.6	152.4	4	19.1
3 ½	215	139.7	122	88.9	22.3	228.6	177.8	8	19.1
4	230	157.2	135	101.6	22.3	304.8	190.5	8	19.1
5	255	185.7	164	127.0	22.3	304.8	215.9	8	22.2
6	280	215.9	192	152.4	23.9	304.8	241.3	8	22.2
8	345	269.9	246	203.2	27.0	304.8	298.5	8	22.2
10	405	323.8	305	254.0	28.6	304.8	362.0	12	25.4
12	485	381.0	365	304.8	30.2	304.8	431.8	12	25.4
14	535	412.8	400	355.6	33.4	304.8	476.3	12	28.6
16	595	469.9	457	406.4	35.0	304.8	539.8	16	28.6
18	635	533.4	505	457.2	38.1	304.8	577.9	16	31.8
20	700	584.2	559	508.0	41.3	304.8	635.0	20	31.8
24	815	692.2	663	609.6	46.1	304.8	749.3	20	35.0

Notes:

(1) Bore (B) is the same as nominal pipe size.

(2) Welding Necks longer than listed are available in all sizes on special order.

CLASS 300 FLANGES

LONG WELDING NECK

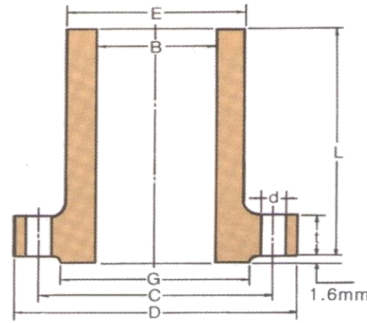

Long Welding Neck Flanges

Class 300

Unit: mm

Nominal Pipe Size	Outside Diam	Hub Diameter of Bevel	O.D. of Raised face	Thickness if Flange Min.	Diameter of Bore	Length through Hub	Drilling Template		
							Diameter or bolt circle	Number of holes	Diameter of holes
	D	E	G	t	B	L	C		d
½	95	38	34.9	12.7	12.7	228.6	66.7	4	15.9
¾	115	48	42.9	14.3	19.1	228.6	82.6	4	19.1
1	125	54	50.8	15.9	25.4	228.6	88.9	4	19.1
1 ¼	135	64	63.5	17.5	31.8	228.6	98.4	4	19.1
1 ½	155	70	73.0	19.1	38.1	228.6	114.3	4	22.2
2	165	84	92.1	20.7	50.8	228.6	127.0	8	19.1
2 ½	190	100	104.8	23.9	63.5	228.6	149.2	8	22.2
3	210	117	127.0	27.0	76.2	228.6	168.3	8	22.2
3 ½	230	133	139.7	28.6	88.9	228.6	184.2	8	22.2
4	255	146	157.2	30.2	101.6	304.8	200.0	8	22.2
5	280	178	185.7	33.4	127.0	304.8	235.0	8	22.2
6	320	206	215.9	35.0	152.4	304.8	269.9	12	22.2
8	380	260	269.9	39.7	203.2	304.8	330.2	12	25.4
10	445	321	323.8	46.1	254.0	304.8	387.4	16	28.6
12	520	375	381.0	49.3	304.8	304.8	450.8	16	31.8
14	585	425	412.8	52.4	355.6	304.8	514.4	20	31.8
16	650	483	469.9	55.6	406.4	304.8	571.5	20	35.0
18	710	533	533.4	58.8	457.2	304.8	628.6	24	35.0
20	775	587	584.2	62.0	508.0	304.8	685.8	24	35.0
24	915	702	692.2	68.3	609.6	304.8	812.8	24	41.3

Notes:

- (1) Bore (B) is the same as nominal pipe size.
- (2) Welding Necks longer than listed are available in all sizes on special order.

CLASS 400 FLANGES

LONG WELDING NECK

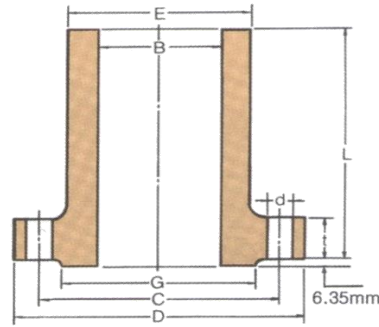

Long Welding Neck Flanges

Class 400

Unit: mm

Nominal Pipe Size	Outside Diameter	O.D. of Raised face	Hub Diameter of Bevel	Diameter of Bore	Thickness if Flange Min.	Length through Hub	Drilling		
							Diameter or bolt circle	Number of holes	Diameter of holes
	D	G	E	B	t	L	C		d
½	Use Class 600 Diameters in these sizes								
¾									
1									
1 ¼									
1 ½									
2									
2 ½									
3									
3 ½									
4	255	157.2	146	101.6	35.0	304.8	200.0	8	25.4
5	280	185.7	178	127.0	38.1	304.8	235.0	8	25.4
6	320	215.9	206	152.4	41.3	304.8	269.9	8	25.4
8	380	269.9	260	203.2	47.7	304.8	330.0	8	28.6
10	445	323.8	321	254.0	54.0	304.8	387.4	12	31.8
12	520	381.0	375	304.8	57.2	304.8	450.8	12	35.0
14	585	412.8	425	355.6	60.4	304.8	514.4	12	35.0
16	650	469.9	483	406.4	63.5	304.8	571.5	16	38.1
18	710	533.4	533	457.2	66.7	304.8	628.6	16	38.1
20	775	584.2	587	508.0	69.9	304.8	685.8	20	41.3
24	915	692.2	702	609.6	76.2	304.8	812.8	20	47.6

Notes:

- (1) Bore (B) is the same as nominal pipe size.
- (2) Welding Necks longer than listed are available in all sizes on special order.

CLASS 600 FLANGES

LONG WELDING NECK

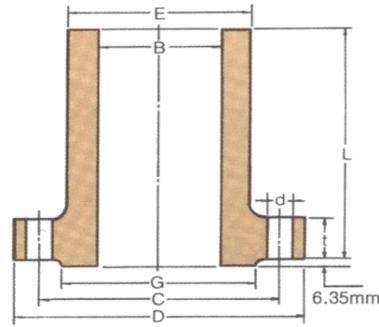

Long Welding Neck Flanges

Class 600

Unit: mm

Nomnal Pipe Size	Outside Diam D	Hub Diameter of Bevel E	O.D. of Raised face G	Thickness if Flange Min. B	Diameter of Bore t	Length through Hub L	Drilling		
							Diameter or bolt circle C	Number of holes	Diameter of holes d
½	95	38	34.9	12.7	14.3	228.6	66.7	4	15.9
¾	115	48	42.9	19.1	15.9	228.6	82.6	4	19.1
1	125	54	50.8	25.4	17.5	228.6	88.9	4	19.1
1 ¼	135	64	63.5	31.8	20.7	228.6	98.4	4	19.1
1 ½	155	70	73.0	38.1	22.3	228.6	114.3	4	22.2
2	165	84	92.1	50.8	25.4	228.6	127.0	8	19.1
2 ½	190	100	104.8	63.5	28.6	228.6	149.2	8	22.2
3	210	117	127.0	76.2	31.8	228.6	168.3	8	22.2
3 ½	230	133	139.7	88.9	35.0	228.6	184.2	8	25.4
4	275	152	157.2	101.6	38.1	304.8	215.9	8	25.4
5	330	189	185.7	127.0	44.5	304.8	266.7	8	28.6
6	355	222	215.9	152.4	47.7	304.8	292.1	12	28.6
8	420	273	269.9	203.2	55.6	304.8	349.2	12	31.8
10	510	343	323.8	254.0	63.5	304.8	431.8	16	35.0
12	560	400	381.0	304.8	66.7	304.8	489.0	20	35.0
14	605	432	412.8	355.6	69.9	304.8	527.0	20	38.1
16	685	495	469.9	406.4	76.2	304.8	603.2	20	41.3
18	745	546	533.4	457.2	82.6	304.8	654.0	20	44.5
20	815	610	584.2	508	88.9	304.8	723.9	24	44.5
24	940	718	692.2	609.6	101.6	304.8	838.2	24	50.8

Notes:

(1) Bore (B) is the same as nominal pipe size.

(2) Welding Necks longer than listed are available in all sizes on special order.

CLASS 900 FLANGES

LONG WELDING NECK

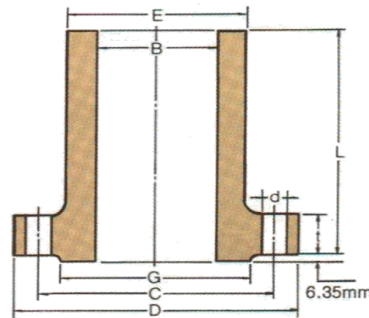

Long Welding Neck Flanges

Class 900

Unit: mm

Nominal Pipe Size	Outside Diameter	O.D. of Raised face	Hub Diameter of Bevel	Diameter of Bore	Thickness if Flange Min.	Length through Hub	Drilling		
							Diameter or bolt circle	Number of holes	Diameter of holes
	D	G	E	B	t	L	C		d
½	Use Class 1500 Diameters in these sizes								
¾									
1									
1 ¼									
1 ½									
2									
2 ½									
3	240	127.0	127	76.2	38.1	304.8	190.5	8	25.4
4	290	157.2	159	101.6	44.5	304.8	235.0	8	31.8
5	350	185.7	190	127.0	50.8	304.8	279.4	8	35.0
6	380	215.9	235	152.4	55.6	304.8	317.5	12	31.8
8	470	269.9	298	203.2	63.5	304.8	393.7	12	38.1
10	545	323.8	368	254.0	69.9	406.4	469.9	16	38.1
12	610	381.0	419	304.8	79.4	406.4	533.4	20	38.1
14	640	412.8	451	355.6	85.8	To be specified by purchaser	558.8	20	41.3
16	705	469.9	508	406.4	88.9		616.0	20	44.5
18	785	533.4	565	457.2	101.6		685.8	20	50.8
20	855	584.2	622	508.0	108.0		749.3	20	54.0
24	1,040	692.2	749	609.6	139.7		901.7	20	66.7

Notes:

- (1) Bore (B) is the same as nominal pipe size.
- (2) Welding Necks longer than listed are available in all sizes on special order.

CLASS 1500 FLANGES

LONG WELDING NECK

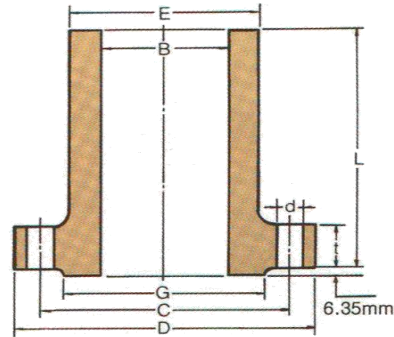

Long Welding Neck Flanges

Class 1500

Unit: mm

Nominal Pipe Size	Outside Diam	Hub Diameter of Bevel	O.D. of Raised face	Thickness of Flange Min.	Diameter of Bore	Length through Hub	Drilling		
							Diameter or bolt circle	Number of holes	Diameter of holes
							C		d
½	120	38	34.9	22.3	12.7	228.6	82.6	4	22.2
¾	130	44	42.9	25.4	19.1	228.6	88.9	4	22.2
1	150	52	50.8	28.6	25.4	228.6	101.6	4	25.4
1 ¼	160	64	63.5	28.6	31.8	228.6	111.1	4	25.4
1 ½	180	70	73.0	31.8	38.1	228.6	123.8	4	28.6
2	215	105	92.1	38.1	50.8	228.6	165.1	8	25.4
2 ½	245	124	104.8	41.3	63.5	304.8	190.5	8	28.6
3	265	133	127.0	47.7	76.2	304.8	203.2	8	31.8
4	310	162	157.2	54.0	101.6	304.8	241.3	8	35.0
5	375	197	185.7	73.1	127.0	304.8	292.1	8	41.3
6	395	229	215.9	82.6	152.4	304.8	317.5	12	38.1
8	485	292	269.9	92.1	203.2	304.8	393.7	12	44.5
10	385	368	323.8	108.0	254.0	406.4	482.6	12	50.8
12	675	451	381.0	123.9	304.8	406.4	571.5	16	54.0
14	750	495	412.8	133.4	355.6	To be specified by purchaser	635.0	16	60.3
16	825	552	469.9	146.1	406.4		704.8	16	66.7
18	915	597	533.4	162.0	457.2		774.7	16	73.0
20	985	641	584.2	177.8	508.0		831.8	16	79.4
24	1,170	762	692.2	203.2	609.6		990.6	16	92.1

Notes:

- (1) Bore (B) is the same as nominal pipe size.
- (2) Welding Necks longer than listed are available in all sizes on special order.

CLASS 2500 FLANGES

LONG WELDING NECK

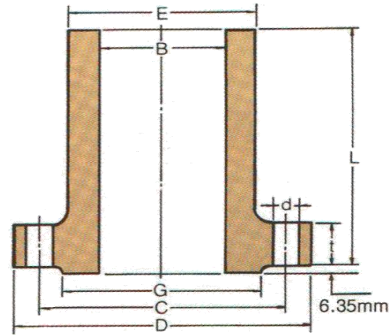

Long Welding Neck Flanges

Class 2500

Unit: mm

Nominal Pipe Size	Outside Diam	O.D. of Raised face	Hub Diameter of Bevel	Diameter of Bore	Thickness of Flange Min.	Length through Hub	Drilling Template		
							Diameter or bolt circle	Number of holes	Diameter of holes
	D	E	G	t	B	L	C		d
½	135	43	34.9	30.2	12.7	228.6	88.9	4	22.2
¾	140	51	42.9	31.8	19.1	228.6	95.2	4	22.2
1	160	57	50.8	35.0	25.4	228.6	108.0	4	25.4
1 ¼	185	73	63.5	38.1	31.8	228.6	130.2	4	28.6
1 ½	205	79	73.0	44.5	38.1	228.6	146.0	4	31.8
2	235	95	92.1	50.9	50.8	228.6	171.4	8	28.6
2 ½	265	114	104.8	57.2	63.5	304.8	196.8	8	31.8
3	305	133	127.0	66.7	76.2	304.8	228.6	8	35.0
4	553	165	157.2	76.2	101.6	304.8	273.0	8	41.3
5	420	203	185.7	92.1	127.0	304.8	323.8	8	47.6
6	485	235	215.9	108.0	152.4	304.8	368.3	8	54.0
8	550	305	269.9	127.0	203.2	304.8	438.2	12	54.0
10	675	375	323.8	165.1	254.0	406.4	539.8	12	66.7
12	760	441	381.0	184.2	304.8	406.4	619.1	12	73.0

Notes:

- (1) Bore (B) is the same as nominal pipe size.
- (2) Welding Necks longer than listed are available in all sizes on special order.